

Standard Features:

- Core only
- Precision aluminum construction for clean styling and efficient air distribution
- Available in lengths up to 144" in one piece (may vary for shipping and manufacturing considerations)
- Maximum available width is 14"
- 1/8" thick core blades run parallel to longest dimension
- 1/2" spacing with 0° or 20° deflection; actual spacing between bars is 3/8"
- 1/3" spacing with 0° or 20° deflection; actual spacing between bars is 3/16"
- Satin Anodized

Options:

- Gym Grade construction with extra center margin supports
- Short Bars: core blades run parallel to shortest dimension
- Special Shapes: mitered and custom shape diffusers (see website for more details)
- Finished flat end caps
- Butt joints for continuous lengths
- Fractional dimensions

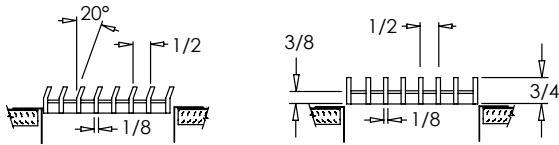

LC 1/2 20°

LC 1/2 0°

Blade Spacing Options:

- 1/2" - 0° Deflection
- 1/2" - 20° Deflection
- 1/3" - 0° Deflection
- 1/3" - 20° Deflection

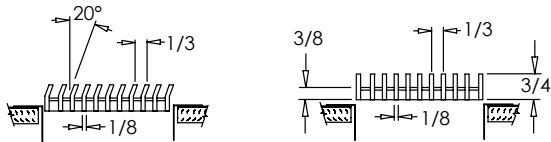

LC 1/3 20°

LC 1/3 0°

Finishes:

STANDARD COLORS

- Soft White
- Driftwood Tan
- Mill Finish
- Satin Anodized

DESIGNER COLORS

- Black
- Bronze
- Storm Gray
- Cement Gray

- Aluminum Paint
- Coffee Tan
- Warm White
- Glossy White

Core Only – Mounting Options:

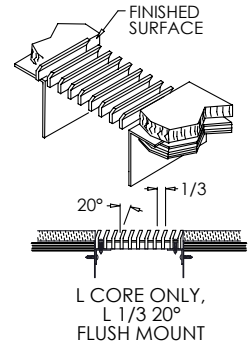
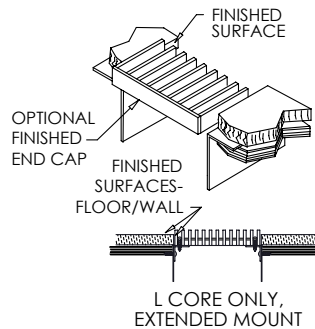
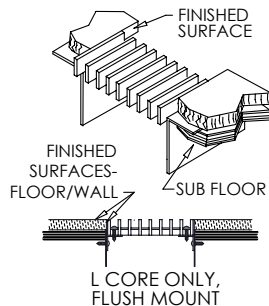
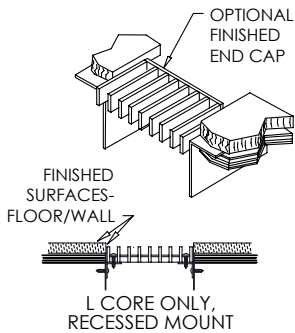

Continued next page.

Core Only – Order and Mounting Information:

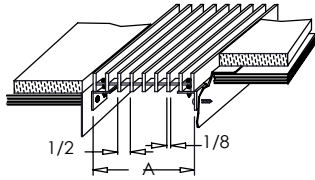

1/2" SPACING DIMENSION "A"
 MADE IN 1" INCREMENTS @ 1/8 & 5/8" OVER THE FULL INCH.
 EXAMPLE: 4 1/8", 6 5/8", ETC.

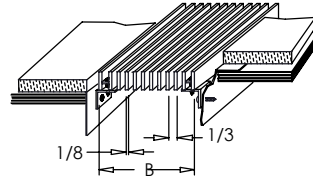

1/3" SPACING DIMENSION "B"
 MADE IN 1" INCREMENTS @ 1/8", 7/16" & 13/16" OVER THE FULL INCH.
 EXAMPLE: 4 1/8", 8 7/16", 6 13/16", ETC.

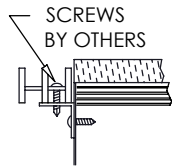

Note:
 Mounting location/Support strength brackets supplied by others. Recommended for floor applications: 16 ga. min. Use heavier gauge brackets more frequently in high traffic areas.

Additional Information:

Submittal Notes

Project / Location:	
Engineer:	
Architect:	
Contractor:	